

Legend

- Barred Owl
- Cooper Hawk
- Cooper Hawk Nesting Buffer
- Eagle Osprey
- Treefrog
- Protected Floral Species
- Wetlands
- Wetlands Line
- Wetlands Buffer Line
- RD to FA Zone**
- Reduced Buffer 300'-175'
- Uplands outside 300' Buffer
- RD to RG Zone**
- Uplands outside 300' Buffer
- Uplands within T & E that will be deed restricted
- RG Zone**
- Uplands to be deed restricted

Proposed Development Areas

- 1 Core Campus Development
- 2 Pomona Community of Learning
- 3 Athletic Complex
- 4 Stockton Towers
- 5 Health Science Campus & Jimmie Leeds Road Commercial
- 6 Research Park
- 7 Administrative Buildings
- 8 Administrative Buildings
- 9 Plant Operations Storage Upgrade
- 10 Research Park Administrative Annex

NOTES:

1. PROPERTY ID: TAX MAP LOTS 1.01 - 1.08, BLOCK 875.04, GALLOWAY TOWNSHIP, ATLANTIC COUNTY, NEW JERSEY, TOTAL AREA OF SUBJECT PROPERTY = 1,573.82 ACRES.
2. SURVEY INFORMATION:
 - A.) BOUNDARY SURVEY: BOUNDARY SURVEY INFORMATION SHOWN HEREON IS BASED ON A FIELD SURVEY BY PENNON ASSOCIATES INC. ON SEPTEMBER 2006 THROUGH FEBRUARY 2007. THIS PLAN DEPICTS CONDITIONS AS THEY EXIST ON THE DATE OF THE FIELD SURVEY. PLAN REFERENCE: BOUNDARY SURVEY FOR THE RICHARD STOCKTON COLLEGE OF NEW JERSEY, PREPARED BY PENNON ASSOCIATES FOR MARATHON ENGINEERING AND ENVIRONMENTAL SERVICES INC., DENNIS S. DIBLASIO, PROFESSIONAL LAND SURVEYOR, NJ LIC# GS02830700, DATED 2/09/07
 - B.) TOPOGRAPHIC SURVEY INFORMATION: TOPOGRAPHIC INFORMATION SHOWN HERE ON IS BASED ON A COLOR PHOTOGRAMETRIC SURVEY PERFORMED BY PROMAPS, DATE OF PHOTOGRAPHY - 8-10-06, 12-16-06, 3-15-05. AERIAL PHOTO SCALE IS 1"=350' WITH 2 FOOT CONTOUR INTERVAL AND A FINAL DRAWING MAP SCALE OF 1"=100'. THIS PHOTOGRAMETRY MEETS NATIONAL MAP ACCURACY STANDARDS FOR ACCURACY OF ONE HALF OF THE CONTOUR INTERVAL SHOWN HERE ON.
 - C.) G.P.S. CONTROL INFORMATION: NEW JERSEY STATE PLANE 1983 AND N.A.V.D. 1988 VERTICAL CONTROL WAS ESTABLISHED WITH SURVEY GRADE G.P.S. EQUIPMENT FOR THE AERIAL CONTROL TARGETS AND BOUNDARY SURVEY UTILIZING THE FOLLOWING N.G.S. MONUMENTS: GALLOWAY 1 MONUMENT-J4438, GALLOWAY 2 MONUMENT-J4439 AND FORK MONUMENT-J2825.
3. ELEVATIONS SHOW HERE ON ARE N.A.V.D. 1988.
4. MARATHON ENGINEERING & ENVIRONMENTAL SERVICES INC. PERFORMED A FIELD EVALUATION DURING THE MONTHS OF AUGUST, SEPTEMBER, OCTOBER AND NOVEMBER 2006 TO DETERMINE THE EXTENT OF WETLANDS ON THE SUBJECT PROPERTY AND WITHIN 300 FEET OF ITS BOUNDARIES THAT ARE REGULATED BY THE NEW JERSEY PINELANDS COMMISSION UNDER THE PINELANDS COMPREHENSIVE MANAGEMENT PLAN. THE DELINEATION WAS CONDUCTED ACCORDING TO THE METHODOLOGY SET FORTH IN THE NEW JERSEY PINELANDS COMMISSION MANUAL FOR IDENTIFYING AND DELINEATING PINELANDS AREA WETLANDS.
5. THE PINELANDS COMMISSION FIELD REVIEWED THE WETLANDS DELINEATION PERFORMED BY MARATHON DURING THE MONTH OF MARCH 2007 TO DETERMINE ITS CORRECTNESS AND VERIFIED THE ACCURACY THEREOF AS PRESENTED ON THIS PLAN (N.J.P.C. FILE NO. 1981-1833.048, LETTERS DATED 11/19/07 AND 3/3/08).
6. OBSERVATIONS OF RARE RAPTORS NOTED ON THIS PLAN ARE DESCRIBED IN THE TEXT OF THE REPORT ENTITLED "PHASE II (PRESENCE/ABSENCE) SURVEY REPORT: COOPER'S HAWK (ACCIPITER COOPERI), RED-SHOULDERED HAWK (BUTEO LINEATUS), BALD EAGLE (HALIAEETUS LEUCOCEPHALUS), AND BARRED OWL (STRIX VARIA) FOR THE RICHARD STOCKTON COLLEGE OF NEW JERSEY, TOWNSHIP OF GALLOWAY, ATLANTIC COUNTY, NEW JERSEY," PREPARED BY MARATHON ENGINEERING & ENVIRONMENTAL SERVICES, INC., DATED MARCH 25, 2009.

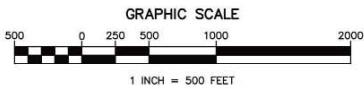
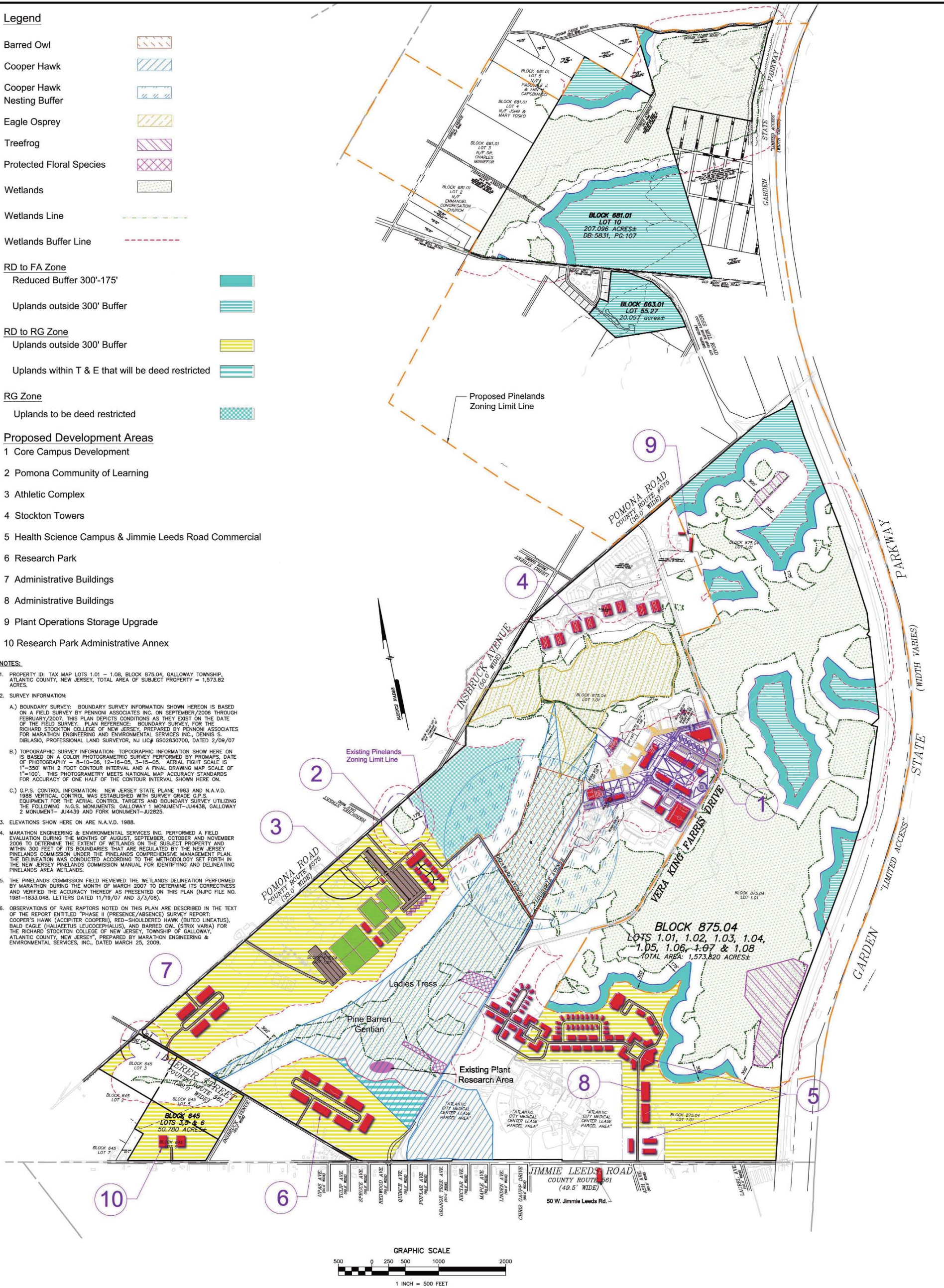

FACILITIES AND PLANT OPERATIONS
 THE RICHARD STOCKTON COLLEGE OF NEW JERSEY
 "Support and service, built on innovation"

NEW JERSEY'S GREEN COLLEGE
 PO BOX 483
 POMONA, NEW JERSEY 08240
 PHONE: 609.652.4281 FAX: 609.748.6216

OVERLAY PLAN

PROPOSED OVERALL CAMPUS MASTER PLAN

REV. DATE	REV. NO.	DESCRIPTION	BY	APP'D	DATE
8/5/09	1	Revised per comments per master plan mtg 7/22/09	KDB		JULY 20, 2009
9/2/09	2	Revised Health Science Campus	KDB		SCALE 1"=500'
9/28/09	3	1st Plant Research Area, 50W Jim Leeds Rd, RD to RG Zone	KDB		DRAWN BY KDB
10/16/09	4	Revised location of area 8	KDB		CHECKED APPROVED